

pompa intermedia - serie XV

XO1-1

POMPA INTERMEDIA ACCOPPIABILE CON XV1
BASE Ø25,4 FEMMINA

X 0 I 06 32 A B B A

Serie	X	serie XV
Gruppo	0	gruppo 0
Categoria	I	pompa intermedia
Cilindrata	06	0.76
Base	32	Ø25.4 femmina rotazione destra 1P+0P
Albero	A	CIP01 - Intermedio per 1+0 - 2+0 (Cilindrico ø7 - M7x1 - linguetta sp.2)
Corpo	IN	aspirazione - 1/4" BSP
	OUT	mandata - 1/4" BSP
Coperchio	A	femmina ø22

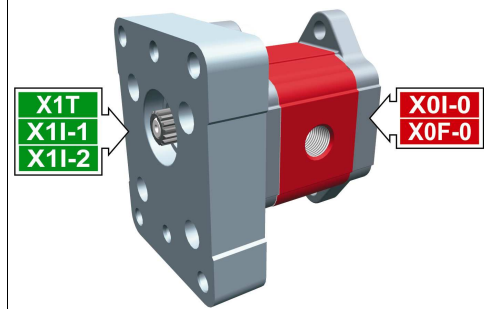

XI003

Tabella dati tecnici

TIPO	Cilindrata cm3/giro	Pressione Max.		CODICE																	
		P1 bar	P3 bar	Rotazione Sinistra		Rotazione destra															
XO1-1/0.17	0,16	220	260	X	0	I	01	31	A	B	B	A	X	0	I	01	32	A	B	B	A
XO1-1/0.25	0,24	220	260	X	0	I	02	31	A	B	B	A	X	0	I	02	32	A	B	B	A
XO1-1/0.45	0,45	220	280	X	0	I	04	31	A	B	B	A	X	0	I	04	32	A	B	B	A
XO1-1/0.57	0,56	220	280	X	0	I	05	31	A	B	B	A	X	0	I	05	32	A	B	B	A
XO1-1/0.76	0,75	220	280	X	0	I	06	31	A	B	B	A	X	0	I	06	32	A	B	B	A
XO1-1/0.98	0,92	220	280	X	0	I	07	31	A	B	B	A	X	0	I	07	32	A	B	B	A
XO1-1/1.27	1,26	220	280	X	0	I	09	31	A	B	B	A	X	0	I	09	32	A	B	B	A
XO1-1/1.52	1,48	220	280	X	0	I	11	31	A	B	B	A	X	0	I	11	32	A	B	B	A
XO1-1/2.30	2,28	190	210	X	0	I	13	31	A	B	B	A	X	0	I	13	32	A	B	B	A

P1) Pressione max. di esercizio - P3) Pressione max. di picco

Per applicazioni gravose si consiglia di verificare la coppia ammissibile dell'albero

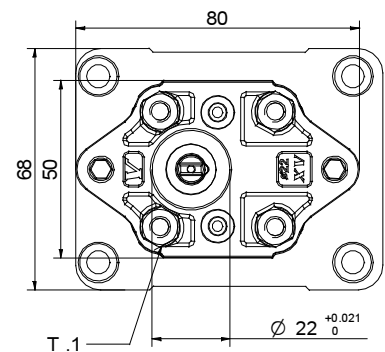

T.2

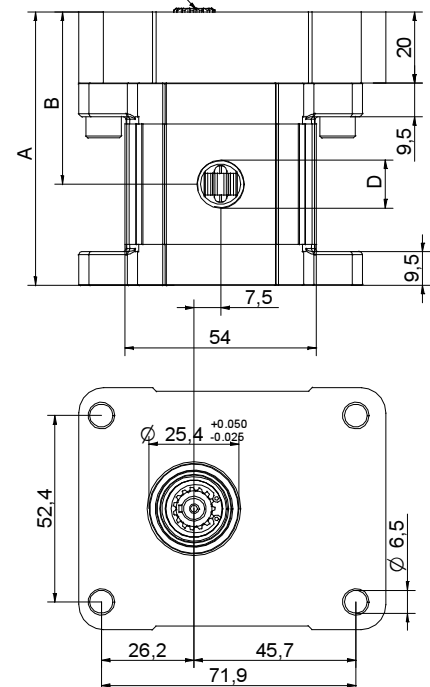

0104/08 X010632ABBA.dff





T.1 = 11.7÷13.7 [Nm] - coppia di serraggio viti M6

T.2 = 2.1 [Nm] - coppia ammissibile dell'albero (N.B. Per la scelta dell'albero verificare sempre la coppia ammissibile).

Tavola delle varianti

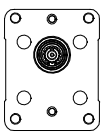
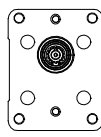
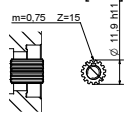
XOI-1

BASE ø25,4 Femmina

BASE ø25,4 Femmina		Albero		Coperchio	
Rotazione Sinistra	Rotazione destra			Rotazione Sinistra	Rotazione destra
		CIP01 - Cilindrico T.2 = 2.1 [Nm] 			
31	32	A		A	A
					
				D	D

Cilindrata	
TIPO	CODICE
XOI-1/0.17	01
XOI-1/0.25	02
XOI-1/0.45	04
XOI-1/0.57	05
XOI-1/0.76	06
XOI-1/0.98	07
XOI-1/1.27	09
XOI-1/1.52	11
XOI-1/2.30	13

Corpi standard	
Cilindrata	cm3/girolettature standard
0.17	B - B
0.25	B - B
0.45	B - B
0.57	B - B
0.76	B - B
0.98	B - B
1.27	B - B
1.52	B - B
2.30	B - B

Tabella con indicate le combinazioni delle flangiature e filettature standard disponibili a magazzino

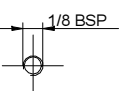
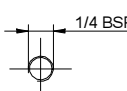
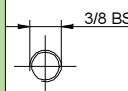
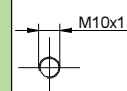
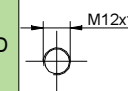
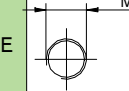
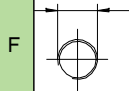
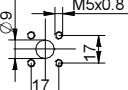
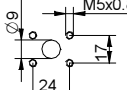
Corpo (filettature e flangiature)													
	A		B		C		D		E		F		G
	H		I	Corpo Chiuso		Z							